

**COVER SHEET
FINAL SUBDIVISION SUBMITTAL
CAPITAN TRADING POST, UNIT 1 AND 2
A TRACT OF LAND WITHIN THE N/2 OF SECTION 10,
TOWNSHIP 9 SOUTH, RANGE 14 EAST, N.M.P.M., VILLAGE
OF CAPITAN LINCOLN COUNTY, NEW MEXICO**

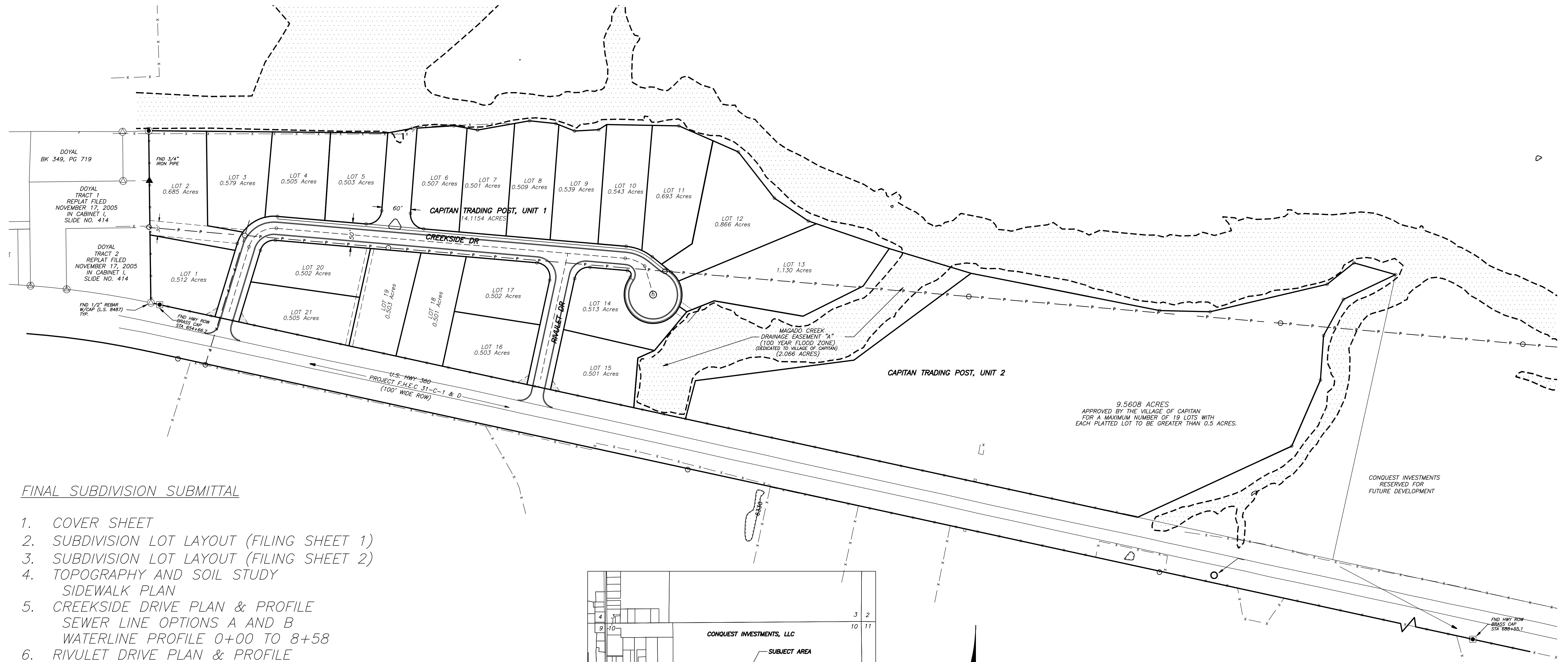

FINAL SUBDIVISION SUBMITTAL

1. COVER SHEET
2. SUBDIVISION LOT LAYOUT (FILING SHEET 1)
3. SUBDIVISION LOT LAYOUT (FILING SHEET 2)
4. TOPOGRAPHY AND SOIL STUDY SIDEWALK PLAN
5. CREEKSIDE DRIVE PLAN & PROFILE SEWER LINE OPTIONS A AND B WATERLINE PROFILE 0+00 TO 8+58
6. RIVULET DRIVE PLAN & PROFILE CREEKSIDE CUL-DE-SAC DETAIL TYPICAL UTILITY MAIN LOCATIONS TYPICAL UTILITY LOCATION DETAIL
7. DETAILS - WATER
8. DETAILS - SEWER
9. DETAILS - LIFT STATION

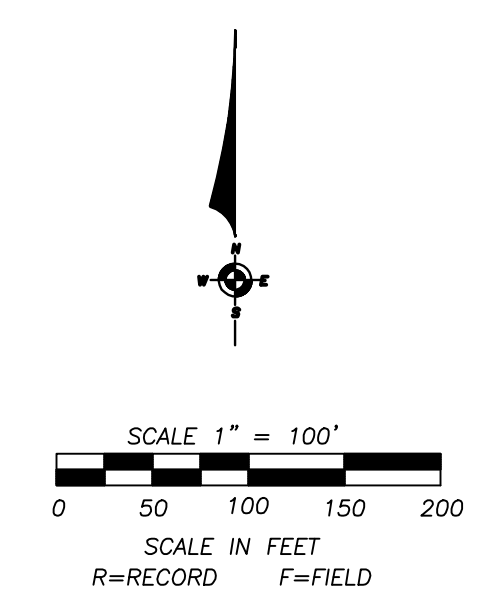
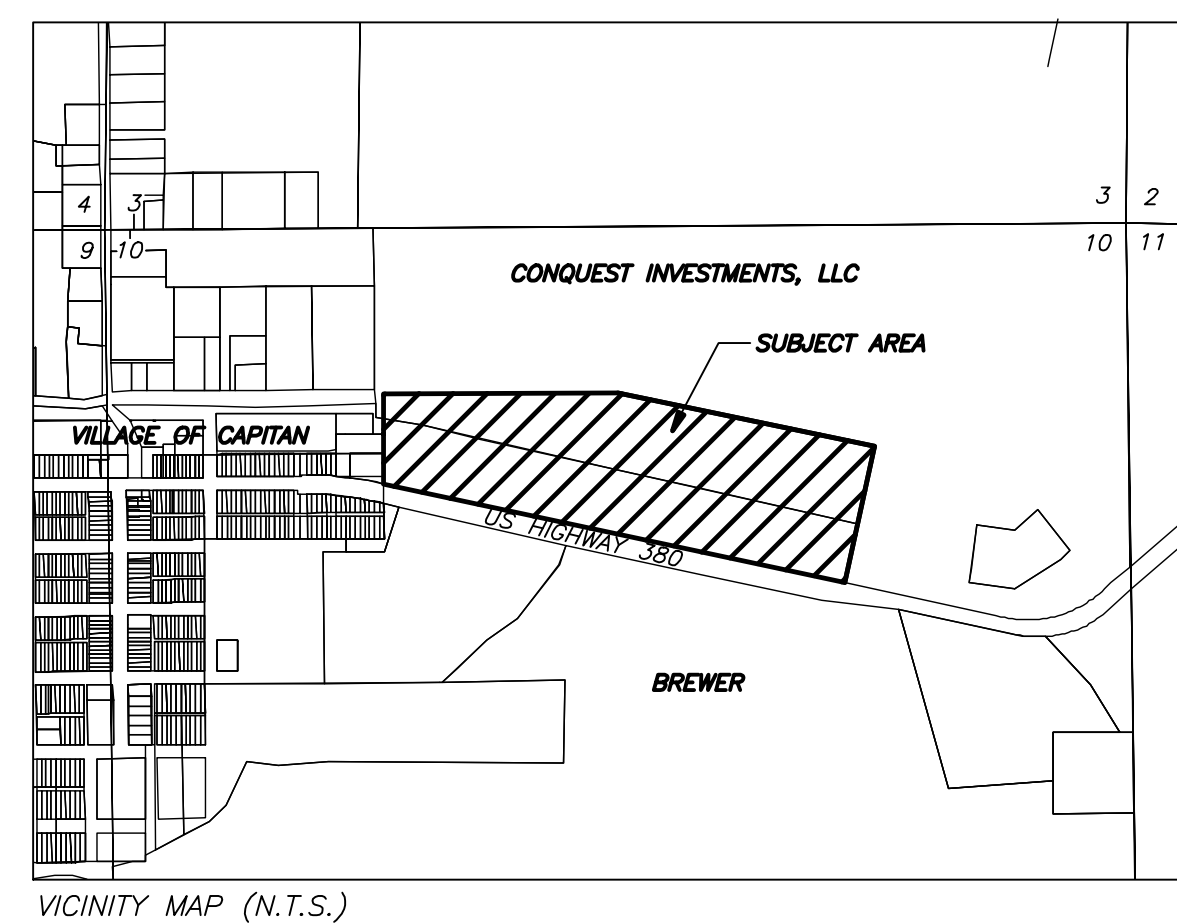

DEVELOPER:
Conquest Investments, LLC
A NM LIMITED LIABILITY COMPANY
P.O. Box 313
Alto, NM 88312



SUBMISSION DATE: 10/27/11

<p>BENCHMARK ENGINEERING SURVEYING PO BOX 1281 RUIDOSO DOWNS, NM 88346 (575) 378-4254</p>		<p>D.T. COLLINS & ASSOCIATES P.C. SURVEYING, MAPPING 1042 MECHEM DR. 575-258-5272 PLS NO. 18077 RUIDOSO, LINCOLN COUNTY, NEW MEXICO</p>	<p>SCALE: 1"=100' DATE: 10-27-11 DRAWN BY: EEC CHECKED BY: PVG JOB NO: 10-708 SHEET 1 OF 9</p>
		<p>CONQUEST INVESTMENTS RESERVED FOR FUTURE DEVELOPMENT</p>	